



1
Unlock and open the frame.



2
Load desired amount of hay in net.



3
Lift the rack and lock to wall.



4
Verify mechanism is in locked position.

MOUNTING & ASSEMBLY INSTRUCTIONS

Please use any necessary safety gear while following instructions.

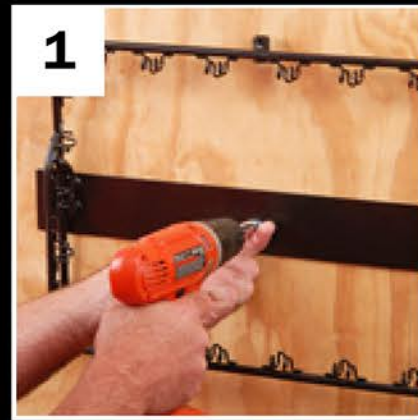

1
Place screw in center of plate in desired location.



2
Use level to determine where the screws on either side of the plate should be placed and place a mark at these locations.

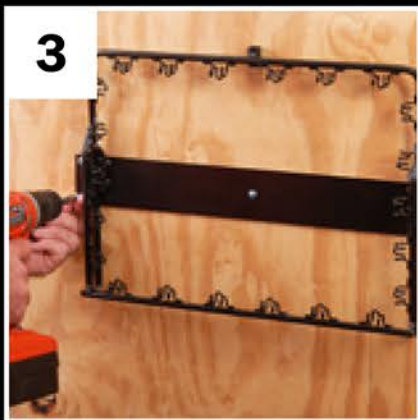

3
Once level place the screws through the plate on each end of the plate (2 each end) where you placed the marks.

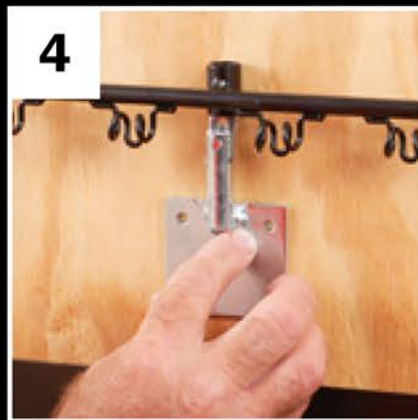

4
Place lock through the tube located at the top of the frame.

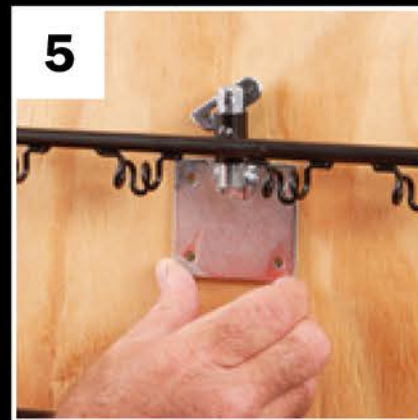

5
Push lock completely through the tube until the locking tab falls into place, make sure lock plate is level and mark screw holes.

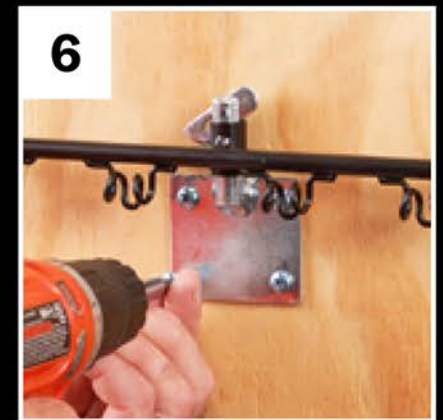

6
Use screws to mount plate where screws marked in previous step. Your lock should look like this when installed correctly.



7
Unlock the frame and lower to apply net to the frame.



8
Starting in the middle of the front of the frame, push the top of the net through and loop the end over the hook as shown.



9
Now that the net is applied raise the frame. When lowering the frame over the lock make sure it is in the unlocked position in order to receive the tube mounted on the frame. See photo #4 for what the unlocked position looks like. Make sure locking tab falls fully to lock frame into position.

**If using a net other than the one that came with the Hay Hoop you may end up with extra loops. You can double up the loops at the rear of the frame.*

Hay Hoops™ should be inspected between every use to ensure it is in proper working order.

Hay Hoops™ used in a lower feeding position should be hung so that the hay net is at least 1' off of the ground. Lock must be used in this position.

Only hay nets with opening less than 2" should be used when hung in lower feeding position.

Feeder should not be used in the lower position if the horse is shod and has the shoe extending beyond the backside of the hoof.